

# YMK Tools®



## *Company Introduction*

ShenZhen YMK INTELLIGENT M&E CO.LTD is a subsidiary company from Shenzhen Yitao Intelligent Control Co.,Ltd., over 30 workers special work for soldering station product line.We specialized in design and manufacturing of innovative and high quality intelligent tools for the electronic manufacturing markets.

YMK Soldering Station uses electromagntic induction heating technology which provides high thermal efficiencyand energy savings compare with traditional resistive method type of soldering machines availableWe also have additional features includes sleep mode and auto power off which further enhance power supplyefficiency (30% power savings compare with traditional products)

YMK soldering machine is one of the leading product brands in the market place,it has the fa-stest heatingresponse time(heats up to 350°C in 15 seconds) with great thermostatic stability ( $\pm 1^{\circ}\text{C}$  when in standby mode,<8°C when in soldering mode)

## *Contact*

Tel:0755-23576730 Fax:0755-23576730

Email:susan-marketing@ymk-tools.com

Office:ymk-tools@ymk-tools.com

Add:Room 2D,Caifu apartment,WanFeng Community,Shajing Street,BaoAan District,ShenZhen,China

## *Production Workshop*



## QC & QA Checking

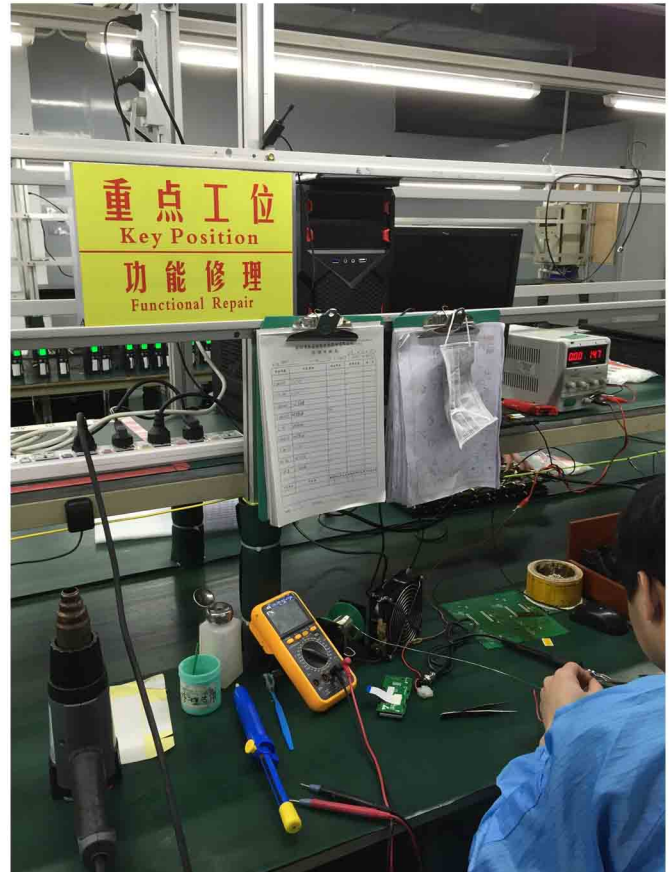
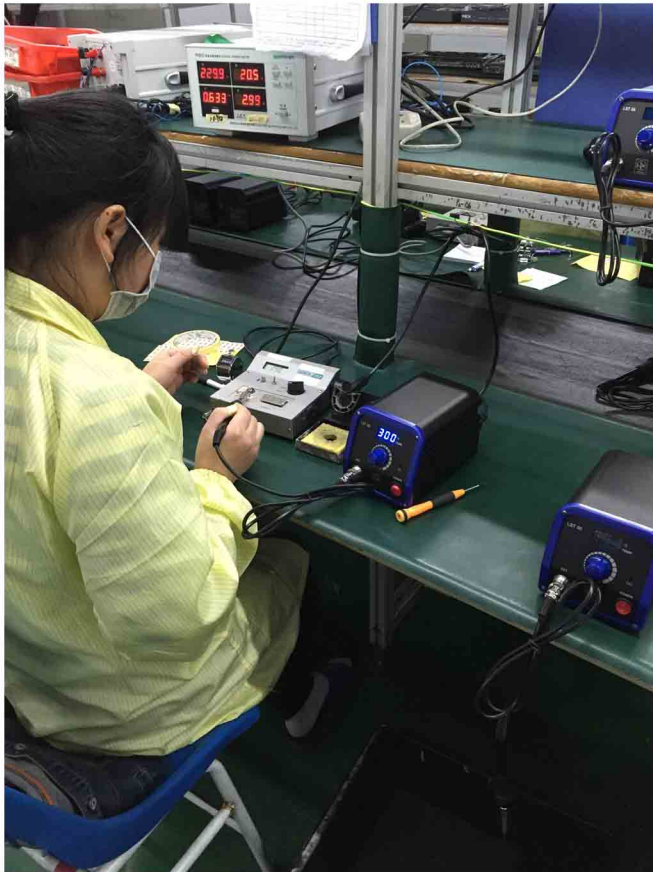

## Warehouse

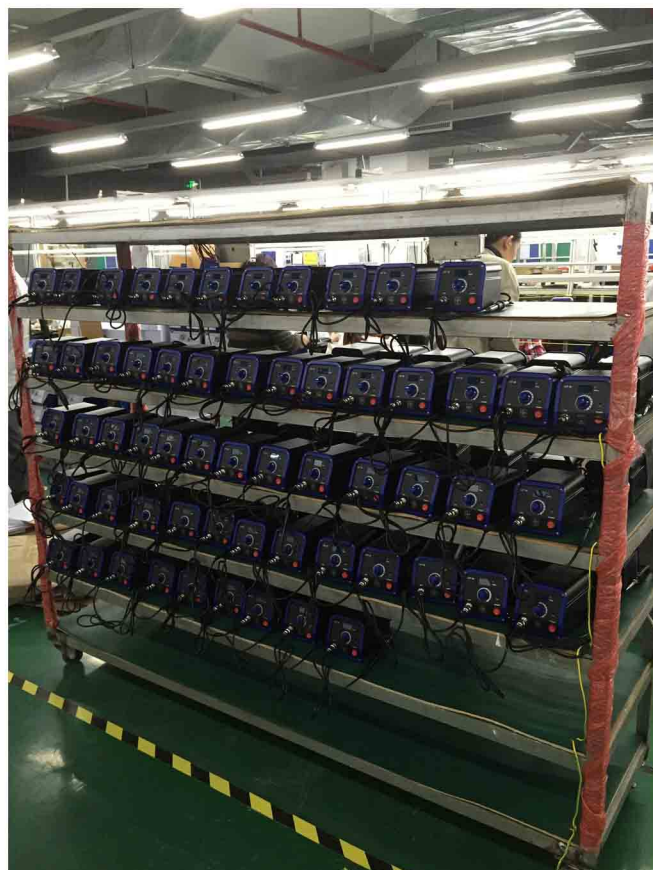



# LEAD FREE SOLDERING STATION FOR YMK SERIES



## MAIN CATEGORIES



Constant Temperature Soldering Station  
YMK M-75D (75 Watt)



High Frequency Soldering station  
YMK RT-S0100 (100watt)



High Frequency Soldering station  
YMK RT-S0150 (150watt)



High Frequency Soldering station  
YMK RT-S0180 (180watt)



Constant Temperature Soldering tips  
RTS-900-TYPE For 75W



High Frequency Soldering tips  
RTS10-TYPE For 100W/150W



Constant Temperature Soldering Heater  
Element HT-75W



High Frequency Soldering heater element  
HT-100/HT-150/HT-180



Soldering iron SI-75W For YMK M-75D



Soldering iron SI-100W/SI-150W For  
YMK RT-S0100/YMK RT-S0150



Soldering iron SI-100W-P/SI-150W-P For  
YMK RT-S0100/YMK RT-S0150



Soldering iron SI-180W For  
YMK RT-S0180



Reach



# High Frequency Soldering Station

**180Watt 50°C ~ 600°C**



## Specifications Soldering Station

Model :	RT-S0180
Power :	180Watt
Input Voltage :	180v ~ 240v
Output Voltage :	AC36V,380KHZ
Temp Range :	50°C ~ 600°C
Environmental Temp :	±1°C (No Load)
25°C Up to 350°C :	28second
Size :	110mm*105mm*175mm
Net Weight :	2.8Kg
Materials Of The Cover :	Aluminum

# High Frequency Soldering Station

**100Watt 150Watt 50°C ~ 600°C**



## Specifications Soldering Station

Model :	RTS-100		RTS-150
Power :	100Watt		150Watt
Input Voltage :	180v ~ 240v		
Output Voltage :	AC36V,380KHZ		
Temp Range :	50°C ~ 600°C		
Environmental Temp :	±1°C (No Load)		
25°C Up to 350°C :	15sec		13sec
Size :	110mm*105mm*155~175mm		
Net Weight :	2.5Kg		2.6Kg
Materials Of The Cover :	Aluminum		

# Ceramic metal Soldering station

**55Watt ,75Watt 200°C - 480°C**



## Specifications Soldering Station

Model :	M-55D		M-75D
Power :	55Watt		75Watt
Input Voltage :	180v ~ 240v		
Output Voltage :	AC36V,380KHZ		
Temp Range :	200°C ~ 480°C		
Environmental Temp :	±5°C (No Load)		
25°C Up to 350°C :	50sec		40sec
Size :	110mm*105mm*155~175mm		
Net Weight :	20Kg		2.1Kg
Materials Of The Cover :	Aluminum		



## Station Details



## Heater Element

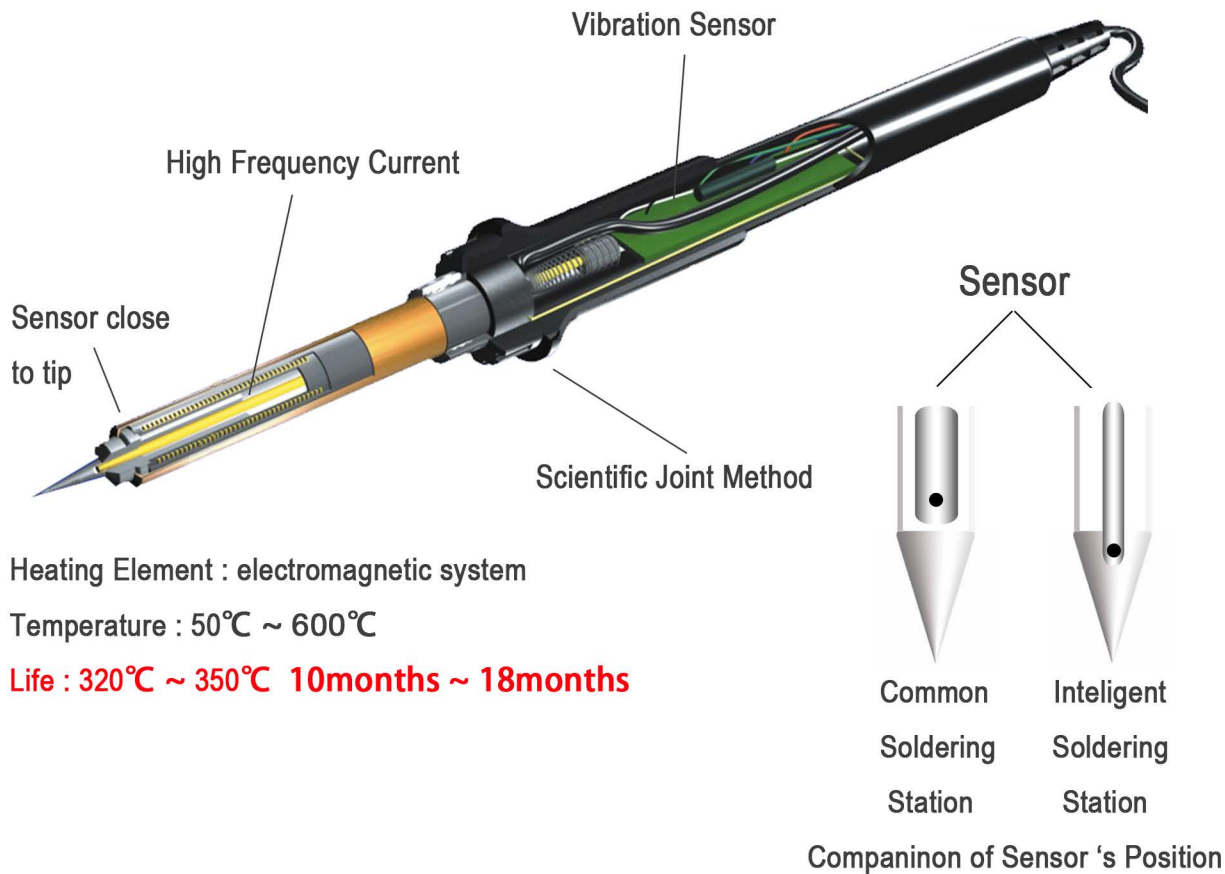

## Specifications Soldering Iron

Model :	SI-100		SI-150		SI-180
Power :	95Watt		145Watt		175Watt
Ground impedance :	< 2Ω				
Ground voltage :	< 2mV				
Insulating resistance :	> 5MΩ				
Heating element :	electromagnetic system				
Power cord :	1.2m				
Holder length :	20cm				
Weight :	100g		105g		155g

## Component & Characteristic details

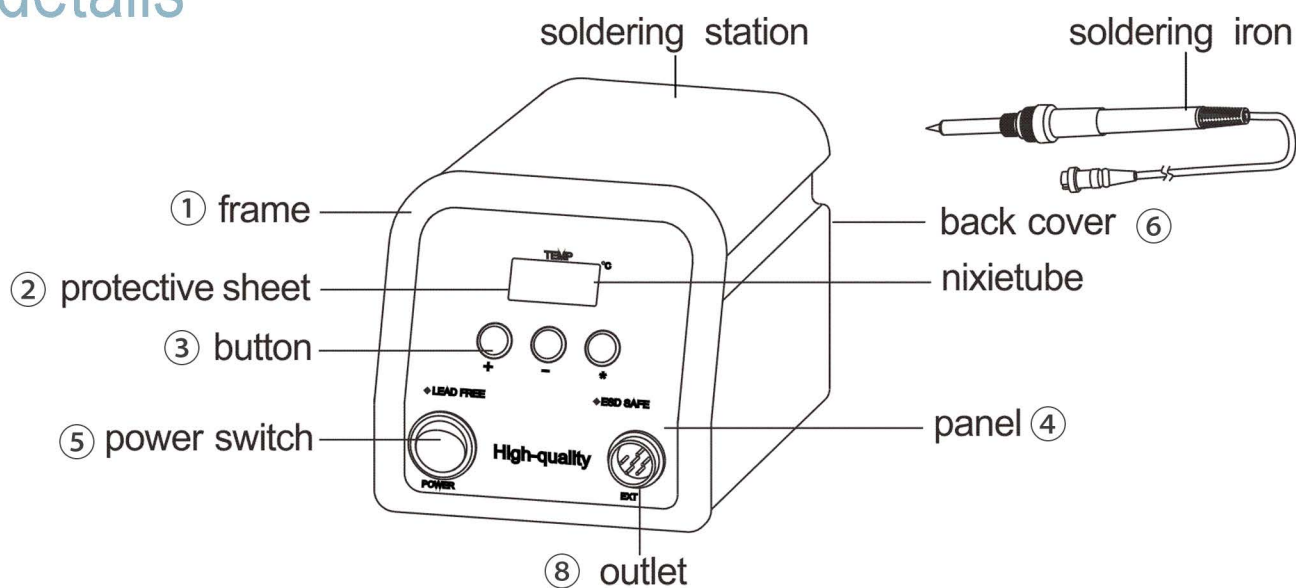

*Auto - sleep	*Reliable power supply
*Auto - off	*Mcu intelligence control
*Lock temp password	*Three nixietube display
*16 operating mode	*Touchone thermostat
*Temp fluctuations $\pm 1^{\circ}\text{C}$ (no load)	*Digital temp calibration
*Temp range $50^{\circ}\text{C} \sim 600^{\circ}\text{C}$	*High frequency eddy current heating
*Soldering temp fluctuations $< 8^{\circ}\text{C}$	*Rapid heating & return temp
*Aluminum shell	*Suitable for lead-free soldering



No.	Part No.	Part Name	Specification				Description
			60W	100W	150W	180W	
1	SS001	surface box	115*108*9mm				ABS material
2	SS002	protective sheet	25*50*1.0mm				tempered glass
3	SS003	button	φ 11.5*8mm				ABS material
4	SS004	panel	110*105*1mm				metal materials
5	SS005	power switch	φ 22mm,6A250VAC				silver alloy contacts
6	SS006	back cover	105*110*1mm				metal materials
7	SS007	power cord	1.5m,6A/250V				3core
8	SS008	aviation socket	M16-6P				metal material
9	SS009	cooling fan	No				DC12V,0.1A dimensions. 45*45*10mm
10	SS010	power transformer	HSD1285H	HSD1283H	HSD1284H	HSD1402H	high quality ring
11	SS011	control board	RT-S0100	RT-S0100	RT-S0150	RT-S0180	glass plate
12	SS012	drive circuit board	RT-S0060	RT-S0100	RT-S0150	RT-S0180	glass plate
13	SS013	grounded Block	φ 8*4mm				alloy plus temp materials
14	SS014	power outlet	10A250VAC				copper temp materials
15	SS015	fuse	2A/250V	3A/250V	3A/250V	3A/250V	φ 5*20mm, fast blow type
16	SS016	Electromagnetic iron	SI-60	SI-100	SI-150	SI-180	electromagnetic heating

## Soldering iron block diagram

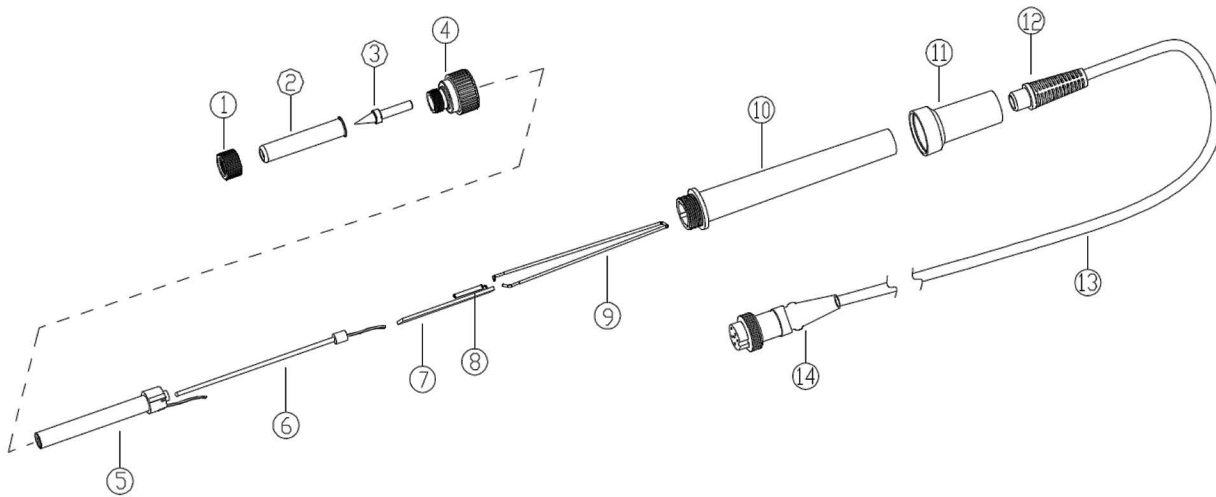

No.	Part No.	Part Name	Specification				Description
			SI-60	SI-100	SI-150	SI-180	
1	SI001	nut	M11				stainless steel
2	SI002	tip sheath	φ 8.5*43mm				stainless steel
3	SI003	soldering tip	φ 4*16.5mm				copper plus coating
4	SI004	hedging	M16*22mm				high temp materials
5	SI005	heater	HT-60	HT-100	HT-150	HT-180	silver wire wound
6	SI006	sensor	φ 2*85mm				K-type thermocouple
7	SI007	board	10*50mm				fiberglass board
8	SI008	vibration switch	SW-18010P				temperature 100°C
9	SI009	hook spring	φ 0.8*86mm				stainless steel
10	SI010	handle	φ 20*110mm				ABS material
11	SI011	handle sheath	φ 22*40mm				EVA
12	SI012	wire sheath	φ 10*40mm				rubber
13	SI013	assembled wire	5core shielded cable, 1.2m				anti-scald silicone line
14	SI014	air plugs	M16-6P				metal

# Temperature curve

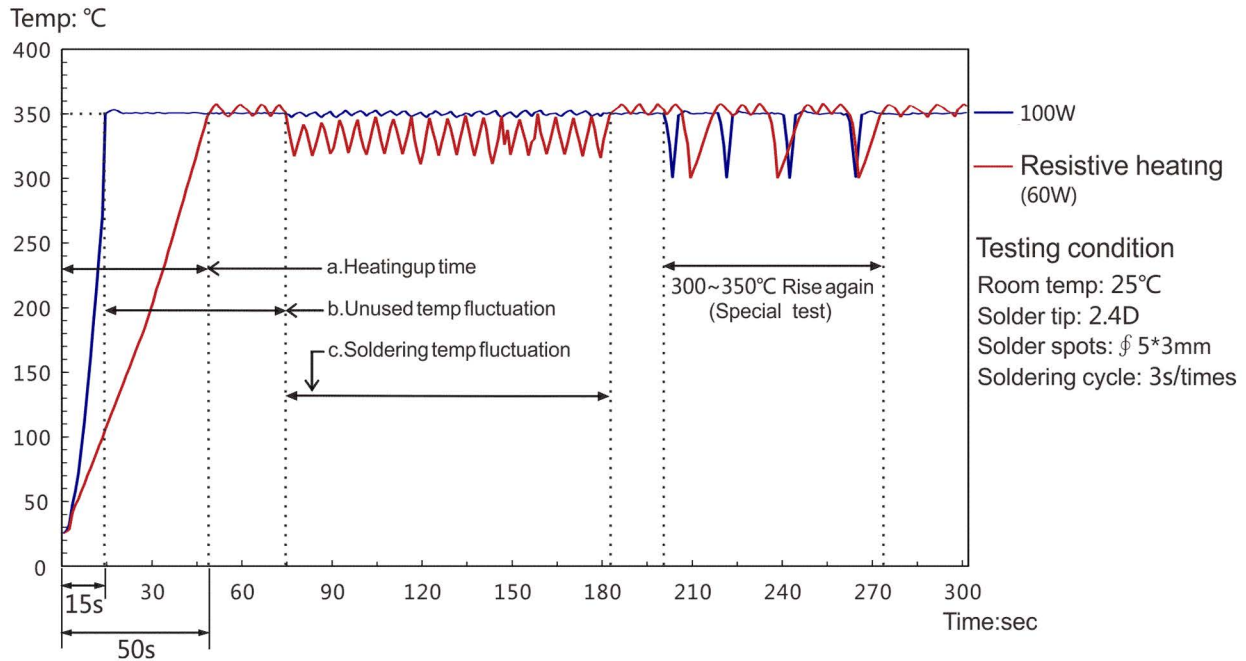

## Quality advantage

Using the high frequency eddy current heating , heating up and return temp at least three times faster than traditional products.

Using the intelligent digital control , which makes the temp more reliability (general temp volatility is less than 8°C) .

So as to make the solder spots more stable、reliability. (because of fast return temp, under the same condition, the setting temp of our product is less 50°C than the traditional one.)

## Solder tips

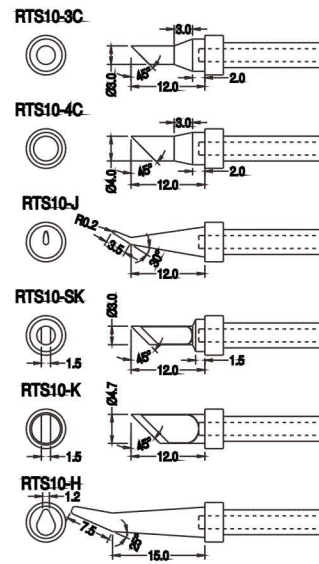
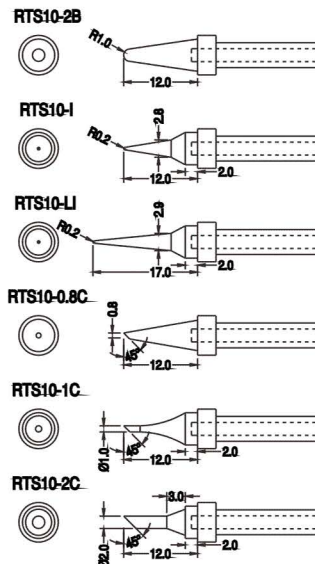
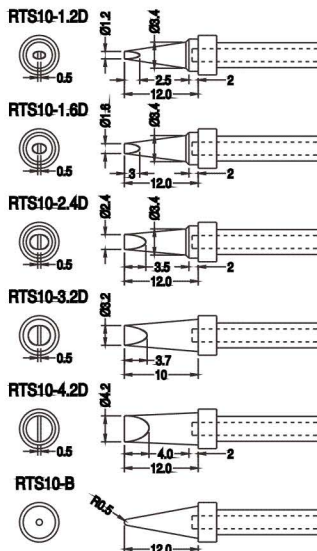

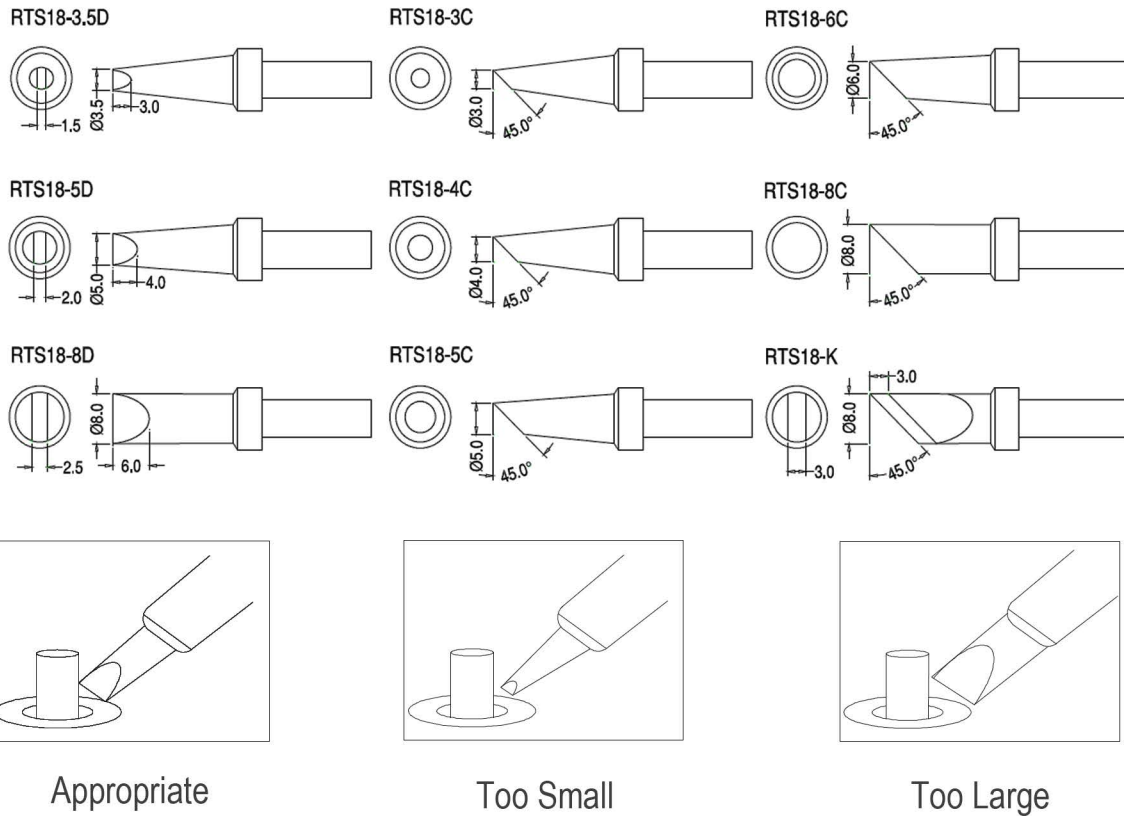

## “Core” technology

Inside use high-quality ring transformer



- \* Much more reliable and safer than switching power supply ;
- \* Applying imported, brand new and high-quality silicon steel for the core :
- \* The winding consist of high-quality and thermostable full-copper enamel wire.
- \* The loss is 25% less than the Eltransformer's;and the electrical efficiency could reach higher than 95% :
- \* The no-load current is 10% of the Eltransformer's; almost free of electromagnetic radiation and vibration noise.
- \*The temperature rises only 40°C during full load operation; durable for long-term full load operation; especially eligible for intense situations.